

NFV

Fan Nozzle with Integral Strainer Option

DESIGN FEATURES

- One-piece construction
- No internal parts
- Male connection
- Low nozzle maintenance
- Optional removable strainer for easy cleaning

Connections: Male NPT and BSP

Optional Strainer: 50, 100, 200 mesh

SPRAY CHARACTERISTICS

- High impact
- Uniform distribution

Spray pattern: Flat Fan and Straight Jet

Spray angles: 0°, 15°, 25°, 40°, 50°, 65°, 80°, 95° and 110°

Flow rates: 0.039 to 49.85 l/min

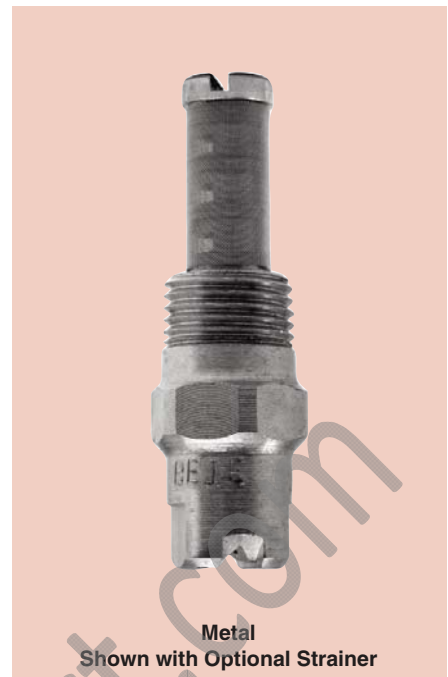

FAN

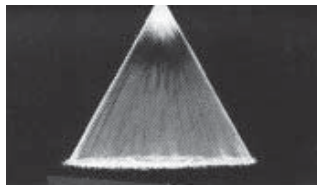

Fan 50°

Call BETE to verify spray angle performance at operating pressures above 30 bar.

NFV Dimensions

| Pipe Size | Dimensions (mm) | | | Wt. (g) |
|-----------|-----------------|------|------|---------|
| | A | B | C | |
| 1/8 | 22.4 | 11.2 | 37.9 | 28.4 |
| 1/4 | 26.9 | 14.2 | 42.9 | 42.5 |

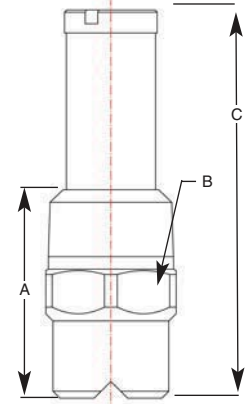

1/8" - 1/4" Metal

To Order: Spray Set-up Number

1/4 **NFV** **0067** **95** **-L** **-B** **303**
pipe size series nozzle number spray angle optional strainer, also specify mesh size specify material BSP thread

NFV Flow Rates

Fan and Straight Jet, 0°, 15°, 25°, 40°, 50°, 65°, 80°, 95°, and 110°, 1/8" and 1/4" Pipe Sizes

| Male Pipe Size | Nozzle Number | K Factor | LITERS PER MINUTE @ BAR | | | | | | Equiv. Orifice Dia. (mm) | Screen Mesh Selection Guide | |
|----------------|---------------|----------|-------------------------|-------|-------|-------|--------|--------|--------------------------|-----------------------------|-----|
| | | | 1 bar | 2 bar | 3 bar | 5 bar | 10 bar | 30 bar | | | |
| 1/8" | NFV0017 | 0.039 | 0.039 | 0.055 | 0.067 | 0.087 | 0.12 | 0.21 | 0.28 | 200 | |
| | NFV0025 | 0.057 | 0.057 | 0.081 | 0.099 | 0.13 | 0.18 | 0.31 | 0.36 | 200 | |
| | NFV0033 | 0.075 | 0.075 | 0.11 | 0.13 | 0.17 | 0.24 | 0.41 | 0.38 | 200 | |
| | NFV0005 | 0.114 | 0.11 | 0.16 | 0.20 | 0.25 | 0.36 | 0.62 | 0.51 | 100 | |
| | NFV0067 | 0.153 | 0.15 | 0.22 | 0.26 | 0.34 | 0.48 | 0.84 | 0.58 | 100 | |
| | or 1/4" | NFV01 | 0.228 | 0.23 | 0.32 | 0.39 | 0.51 | 0.72 | 1.25 | 0.66 | 100 |
| | | NFV015 | 0.342 | 0.34 | 0.48 | 0.59 | 0.76 | 1.08 | 1.87 | 0.79 | 100 |
| | | NFV02 | 0.456 | 0.46 | 0.64 | 0.79 | 1.02 | 1.44 | 2.50 | 0.91 | 100 |
| | | NFV025 | 0.569 | 0.57 | 0.80 | 0.99 | 1.27 | 1.80 | 3.12 | 1.02 | 50 |
| | | NFV03 | 0.684 | 0.68 | 0.97 | 1.18 | 1.53 | 2.16 | 3.75 | 1.09 | 50 |
| NFV04 | | 0.912 | 0.91 | 1.29 | 1.58 | 2.04 | 2.88 | 5.00 | 1.32 | 50 | |
| NFV05 | | 1.139 | 1.14 | 1.61 | 1.97 | 2.55 | 3.60 | 6.24 | 1.45 | 50 | |
| NFV06 | | 1.367 | 1.37 | 1.93 | 2.37 | 3.06 | 4.32 | 7.48 | 1.57 | 50 | |
| NFV07 | | 1.598 | 1.60 | 2.26 | 2.77 | 3.57 | 5.05 | 8.75 | 2.08 | 50 | |
| NFV08 | | 1.823 | 1.82 | 2.58 | 3.16 | 4.08 | 5.76 | 9.98 | 1.83 | 50 | |
| 1/4" | NFV10 | 2.279 | 2.28 | 3.22 | 3.95 | 5.10 | 7.21 | 12.48 | 2.03 | 50 | |
| | NFV15 | 3.418 | 3.42 | 4.83 | 5.92 | 7.64 | 10.81 | 18.72 | 2.39 | 50 | |
| | NFV20 | 4.550 | 4.55 | 6.44 | 7.88 | 10.18 | 14.39 | 24.92 | 2.77 | 50 | |
| | NFV30 | 6.826 | 6.83 | 9.65 | 11.82 | 15.26 | 21.58 | 37.39 | 3.58 | 50 | |
| | NFV40 | 9.101 | 9.10 | 12.87 | 15.76 | 20.35 | 28.78 | 49.85 | 3.96 | 50 | |

Flow Rate (L/min) = $K \sqrt{\text{bar}}$ Standard Materials: Brass and 303 Stainless Steel. Highlighted NFVs available in 316 Stainless Steel.

Spray angle performance varies with pressure. Contact BETE for specific data on critical applications.

TO ORDER: specify pipe size, connection type, nozzle number, spray angle, and material.